

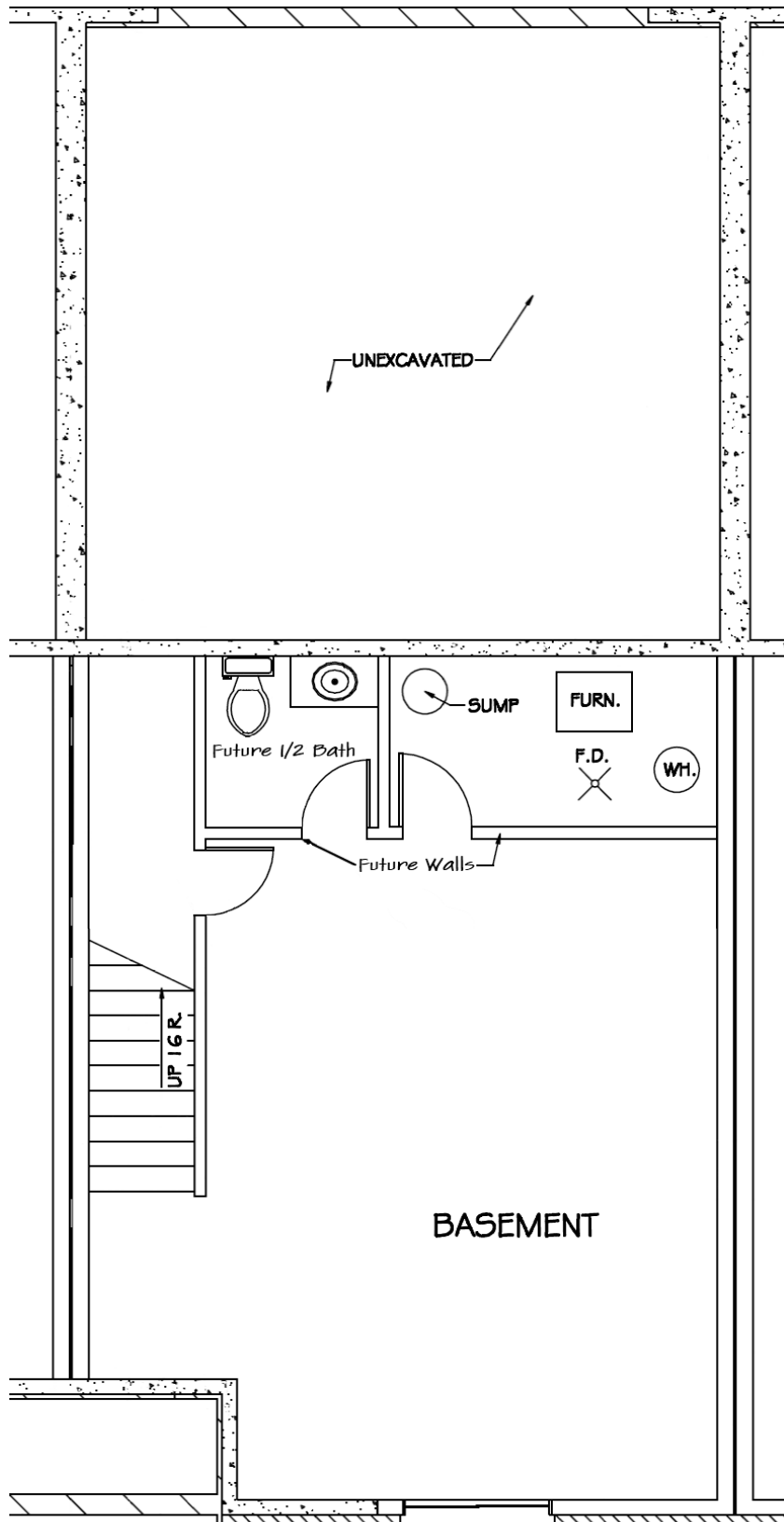

# The Pierson

## Lower Level





# The Pierson

◦ Welcome Home ◦ Victoria, MN ◦

"A City of Lakes and Parks"

## Main Level

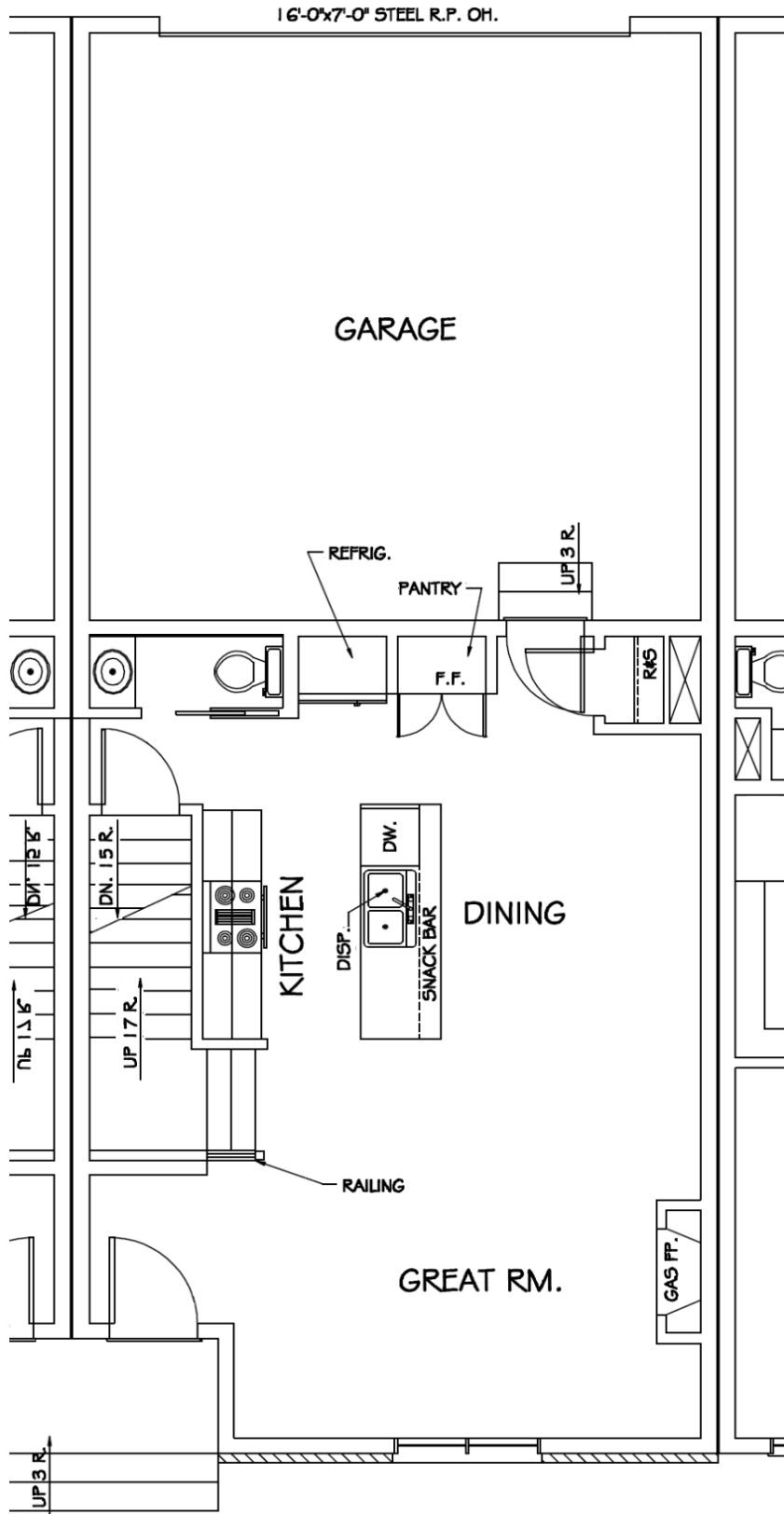



# The Pierson

## Upper Level

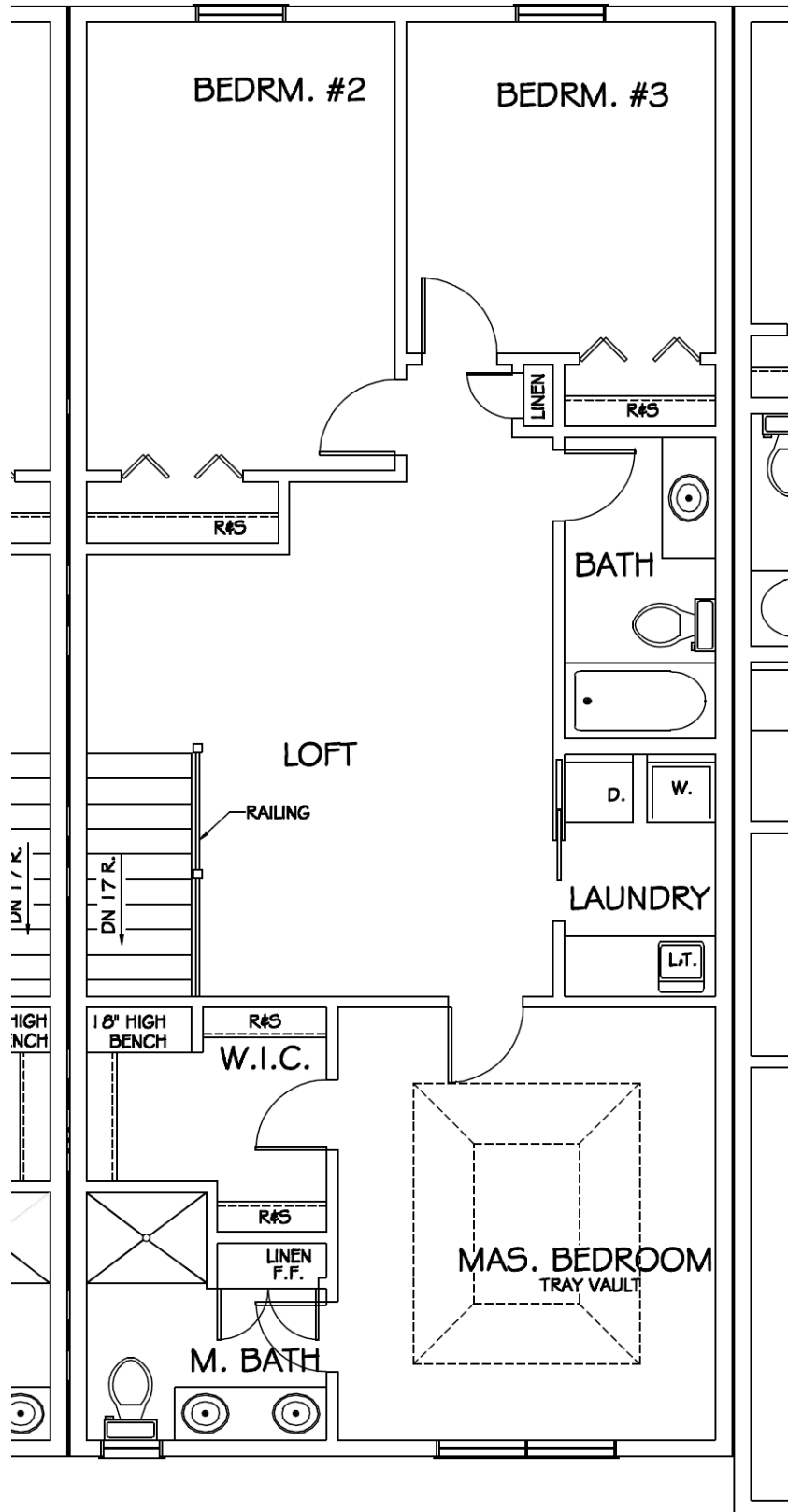



## Unit Features

### **The Pierson - \$218,000.00**

- **Middle unit**
- **3 - bedrooms including a master suite**
- **Includes granite kitchen island counter top**
- **Includes granite master bath vanity tops**
- **Main level 1/2 bath**
- **2 - upper level baths including a master bath**
- **2 - car garage 22' X 21' deep**
- **Total finished area of 1708 square feet**
- **Future unfinished basement that will add another 486 square feet**
- **Additional plumbing for a 1/2 bath in the lower level**
- **Storage in basement**
- **Total potential finished area is 2326 square feet with finished basement area**